

Single – phase isolation transformers

2.2 Type TRU 2 - 16 KVA vertical

Corresponding to VDE 0570/ DIN EN 61558-2-4

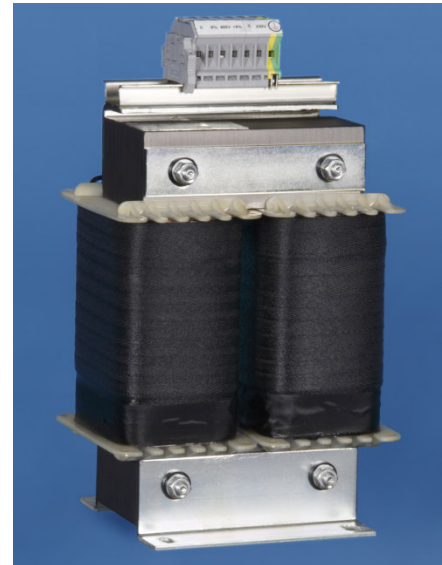
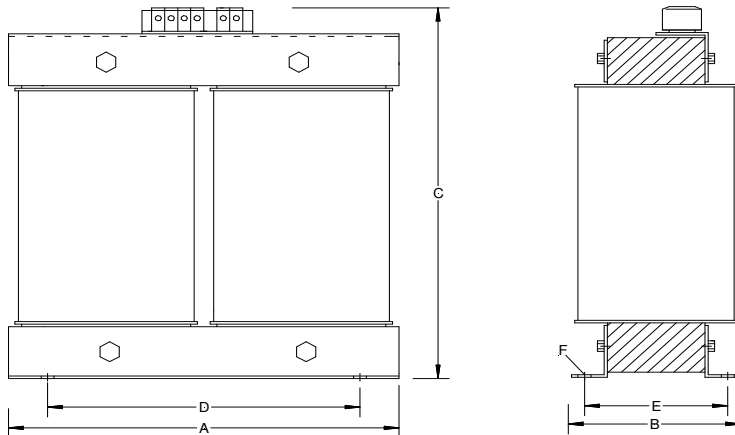

Construction:

Open transformer separate windings. Fixed with angle irons.
Type protection IP 00 suitable for installations up to IP 23.
Corrosion protection via complete impregnation. Insulation class T40E.

Type	Power KVA	Design size Core	Copper Weight kg	Total weight kg	Dimensioning					
					A mm	B mm	C mm	D mm	E mm	F mm
TRU 2.0	2.0	UI 132	4.9	21.0	176	141	228	112	102.0	10.0
TRU 2.5	2.5	UI 150	7.5	25.0	200	135	260	124	107.0	10.0
TRU 3.0	3.0	UI 150	8.8	33.0	200	147	260	124	119.0	10.0
TRU 4.0	4.0	UI 168a	11.5	27.0	226	138	357	136	110.0	11.0
TRU 5.0	5.0	UI 168	12.8	31.5	226	172	357	136	144.0	11.0
TRU 6.3	6.3	UI 210a	16.5	57.0	280	173	360	176	143.0	12.0
TRU 8.0	8.0	UI 210a	16.5	59.0	280	173	428	176	143.0	12.0
TRU 10.0	10.0	UI 210	20.0	70.0	280	188	428	176	158.0	12.0
TRU 12.5	12.5	UI 210	24.0	85.0	280	203	428	176	173.0	12.0
TRU 16.0	16.0	UI 210	28.0	102.0	280	233	428	176	203.0	12.0

Standard voltages:

Primary 230 V and/or 400 V
Secondary 24 V or 230 V
Other voltages on request

Ordering example:

Primary 400 V
Secondary 230 V 2.0 KVA
Reference number: TRU2.0400230