

Transformers for medically used premises

6.3 Type MDT 0.2 – 6.3 KVA Three - phase

Corresponding to VDE 0570/ DIN EN 61558-2-15

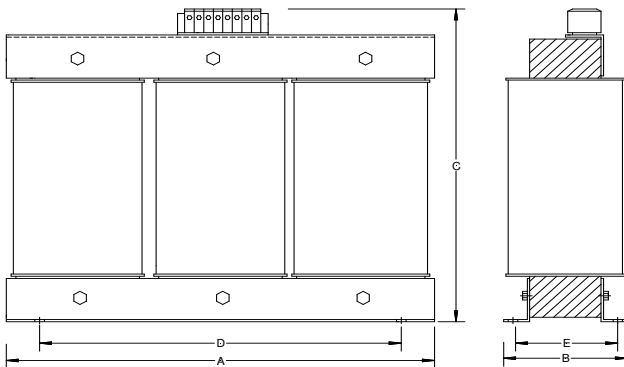

Construction:

Open transformer separate windings. Type protection IP 00 suitable for installations up to IP 23. Corrosion protection via complete impregnation. Max. ambient temperature 40° C Insulation class „E“.

For medically used premises. Fixed with angle irons protective winding between primary and secondary. Including centre tapping.

Type	Power VA	Design size Core	Copper weight kg	Total weight kg	Dimensioning					
					A mm	B mm	C mm	D mm	E mm	F mm
MDT 0.20	200	3 UI 75	1.4	4.2	150	85	136	113	50	5.8
MDT 0.32	320	3 UI 75	1.6	5.8	150	100	136	113	65	5.8
MDT 0.40	400	3 UI 75	1.6	5.8	150	100	136	113	65	5.8
MDT 0.50	500	3 UI 90	1.8	6.5	180	92	157	136	57	8.0
MDT 0.80	800	3 UI 90	2.9	10.4	180	112	157	136	77	8.0
MDT 1.00	1000	3 UI 114	3.4	14.0	228	104	198	176	71	7.0
MDT 1.60	1600	3 UI 120	5.8	19.0	240	117	208	185	81	10.0
MDT 2.00	2000	3 UI 120	6.9	23.0	240	132	208	185	96	10.0
MDT 3.15	3150	3 UI 150	12.0	42.0	300	147	260	224	119	10.0
MDT 4.00	4000	3 UI 150	13.0	42.0	300	160	260	224	132	10.0
MDT 5.00	5000	3 UI 180	15.0	51.0	360	153	305	264	125	10.0
MDT 6.30	6300	3 UI 180	18.0	60.0	360	168	305	264	140	10.0